

Schedule of openings		Area calculation (Core)	
Name	Size w x h		
D3	800x2100	Boys toilet block	4.56 sqm
D4	700x2100	Girls toilet block	6.93 sqm
D5	800x1600	Water tank	0.67 sqm
V1	800x450	Wash area	0.29 sqm
V2	450x450	Landing+Steps	2.17 sqm
V4	300x450	Total Overall Area	14.62 sqm
		Total Covered Area	12.45 sqm

Notes

1. This design is valid for brick strength not below 35kg/sq.cm.
2. Foundation design is only indicative & may need review based on local site conditions.
3. For masonry water tank, the foundation shall be in 230mm brick up to the base of the tank.
4. Mortar 1:4 for 115mm thick masonry. No reinforcement bars in alternate courses.
5. This design is valid for earth quake zone I, II and III only
6. No water supply or waste water carrying pipe shall be concealed in the masonry wall. It shall be exposed and fixed with clips and not chased in masonry walls.
7. In case the masonry specification is changed from that given here, maintain the internal clear dimensions & the layout and provide suitable redesigned foundation.
8. Sloping roof overhang and its anchorage design may need review in cyclone prone regions.
9. In case roof specifications are changed from that given here (e.g. flat roof in stone or RCC) provide suitable strengthening of masonry while maintaining all internal clearances in the layout design.
10. Only one metallic / masonry Incinerator to be put along the location indicated as ICN.
11. Incinerator to be provided only with Girls toilet and to have chute from inside.
12. Location of leach pits, soak pits, waste drainage pipes & inspection chamber is indicative only. Actual location to be decided based on site conditions.
13. Minimum distance of leaching pit from building foundation to be 125cm in different soil types.
14. Design of leach pit shown is for 80+80-180 children with its volume sufficient for catering approximately six months in different soil types. For higher capacity or longer duration, design will need review.

Key to symbols:

1. - - - - - Pipe carrying waste water from wash area to flush urinals.
2. - - - - - Open / Covered drain for waste from Urinal / Squatting pan.
3. [Hatched pattern] Masonry wall.
4. [Dotted pattern] Roof line.

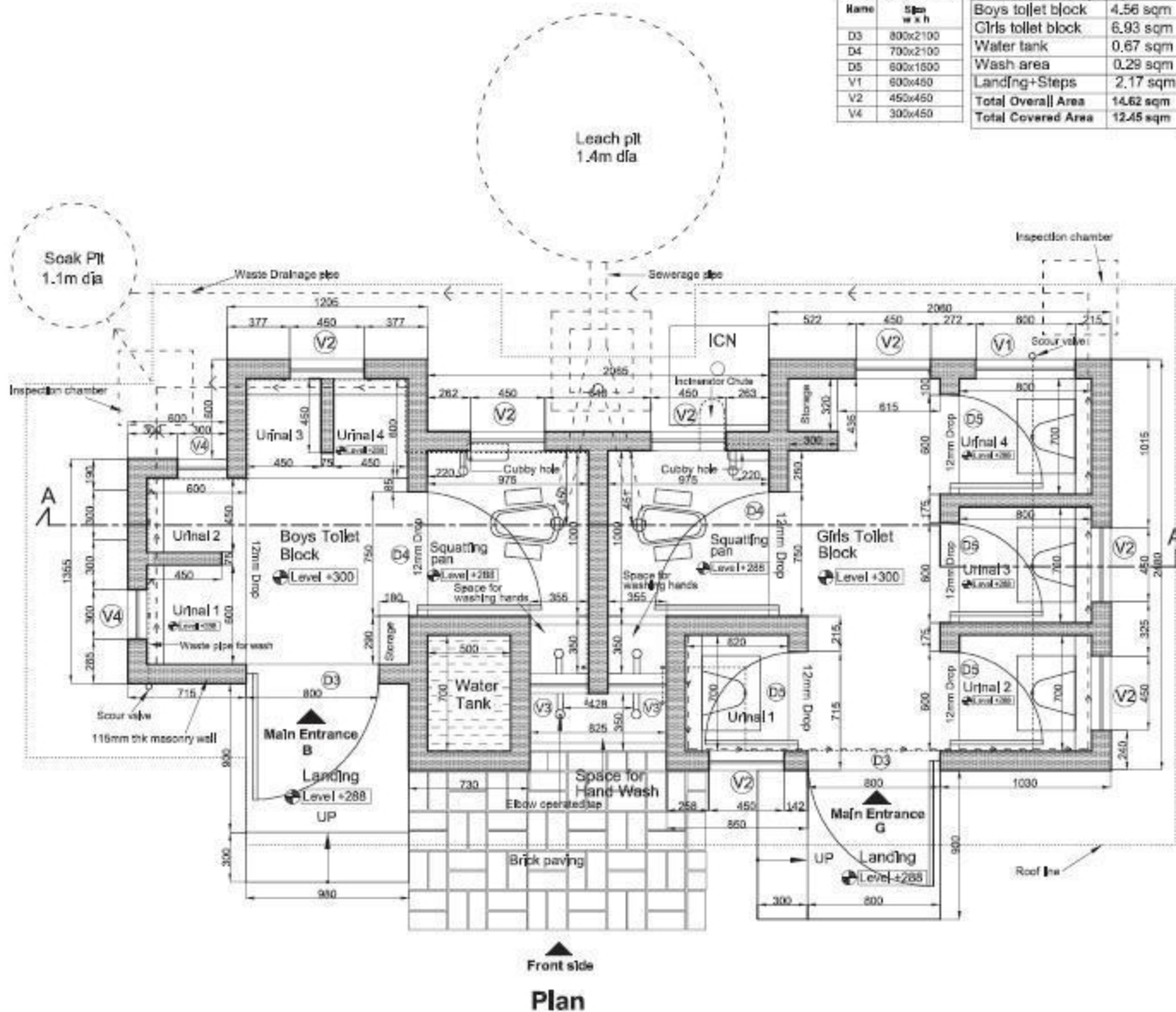

Proposed Toilet 80 G+ 80 B

Plan

Note: The Unit Cost of Toilet varies from State to State. However, the national average cost of construction for Combined Boys and Girls Toilet Block is Rs. 2.70 lakhs.